

## Streamline

*Outside broadcast solutions from four to 24 or more cameras: pre-engineered, modular designs to create the workspace you need, quickly and cost-effectively*



# Meet our Streamline concept

---

Our „pre-engineered“ and „fast delivery“ Streamline concept takes it to the next level!



<i>Standard designs, tailored to your needs</i>	4
<i>The Streamline advantage</i>	5
<i>Streamline concept overview</i>	6
<i>The Streamline matrix</i>	7
<i>The Streamline concept</i>	10
<i>Tech packages</i>	20
<i>Technology for today and tomorrow</i>	21
<i>Streamline IP powered by EVS</i>	22
<i>IP-ready baseband routing</i>	23
<i>Streamline common features</i>	24
<i>Support vans and generators</i>	26
<i>hi human interface</i>	27

---

# Standard designs, tailored to your needs

*Broadcast Solutions has designed, built and delivered more than 500 outside broadcast units covering major sports and live events around the world.*



## Success

Streamline brings all that knowledge and expertise together to create a unique and powerful proposal: an outside broadcast platform that is highly configurable, but built on pre-engineered elements. You get exactly the production facilities you need, delivered quickly and cost effectively.

In the ever-changing business of live broadcast production, interconnectivity and scalability are pivotal for success. Streamline provides sophisticated solutions for real time network connectivity, decentralised router capabilities, remote productions, signal distribution and processing, a solid grounding to move forward to full IP infrastructures, and fully 4K Ultra HD capable.



## Comfort

Streamline units are flexible to meet your requirements, from four cameras in a panel van up to 24 or more cameras in a triple-expanding trailer. Whatever the capacity, the systems are built on the same proven engineering, allowing you to scope and scale the functionality you need.

Future-proof technology is allied with ergonomic workspace design and simple and intuitive system control. To ensure perfect productivity, we place high importance on climate control to meet the conditions you will need, keeping staff comfortable with precise temperature regulation and plentiful fresh air.

# The Streamline advantage

*Unleash production power fast with pre-engineered efficiency.  
Streamline OBs are the future of live production.*



Broadcast Solutions has brought its unrivalled knowledge and experience in design and build to offer highly customisable trucks as standardised products, with all the advantages that brings:

- Uncompromised quality, including stunning 4K and HDR
- Rapid deployment with comprehensive and intuitive system control
- Effortless adaptability and workspace flexibility
- Future-proofed technology to protect the investment
- Fast delivery, delivering a quick return on investment
- Significant cost savings through standardised design modules





## *Streamline concept overview*

*Streamline offers an outside broadcast platform that is highly configurable but built on pre-engineered elements to meet your requirements, from four cameras in a panel van to 24 or more cameras in a double-expanding trailer.*

# The Streamline matrix

Layouts/vehicles/builds are available in a range of fully pre-engineered technology packages.



We are pleased to introduce our versatile range of OB van an layouts, meticulously designed to cater to the diverse requirements of broadcast professionals. Our offerings are categorised by *Vehicle Type* and *Size*, ensuring you can find the ideal solution for your production needs, whether working in compact urban environments or outdoor production settings.

We offer nine Streamline OB models with dedicated technology packages, differentiated by *Vehicle Type*

and *Size: Panel Van, Truck, and Trailer*. Each *Vehicle Type* is further categorised by *Size*:

- ▶ **Panel Van:** Small
- ▶ **Truck:** Medium and Large
- ▶ **Trailer:** Medium and Full-size

Two Streamline models with integrated storage for the *Truck* and *Trailer Vehicle Types* ensure all your equipment is securely stowed and easily accessible.

OB van layout	S4	S8	S8L	S12T	S16T	S16C	S12	S16	S24
Vehicle type	Panel van	Truck				Trailer			
Size	Small	Medium		Large		Medium	Full-size		
Storage integrated		Storage integrated				Storage integrated			

## Different sizes for every need

Whether you require the compact convenience of a Panel Van, the robust capabilities of a Truck, or the expansive space provided by our Trailers, our range of OB van layouts is designed to meet your specific production needs. With integrated storage in select models, you can rest assured that your equipment is secure, accessible, and ready for action.



---

## Panel Van

---

**S4**

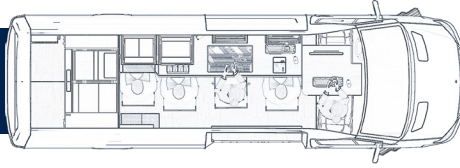

Small-size OB in a panel van

---

## Truck

---

**S8**

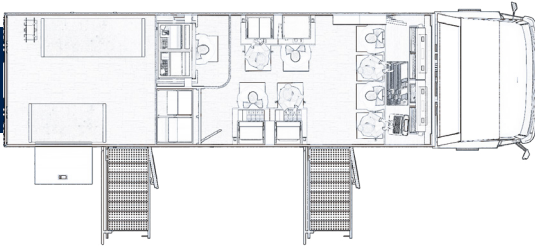

Medium-size OB truck with integrated storage

**S8L**

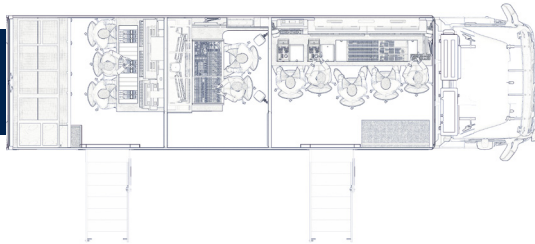

Medium-size OB truck

**S12T**

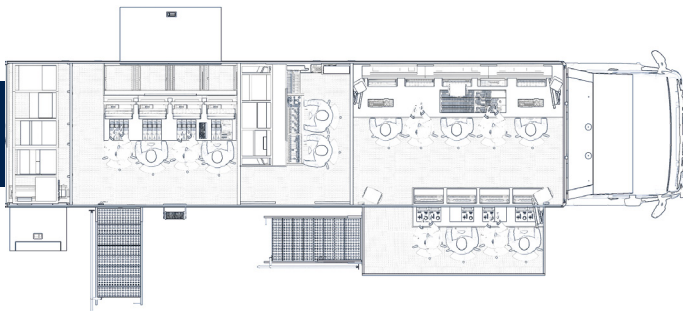

Large-size OB truck

**S16T**

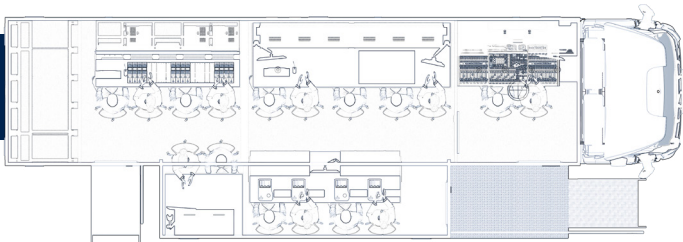

Large-size OB truck

---

## Trailer

---

**S16C**

Medium-size OB trailer

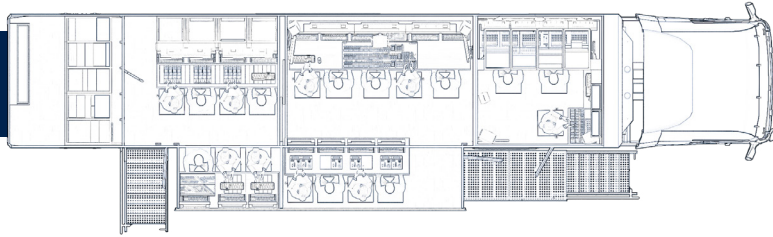

**S12**

Full-Size OB trailer with integrated storage

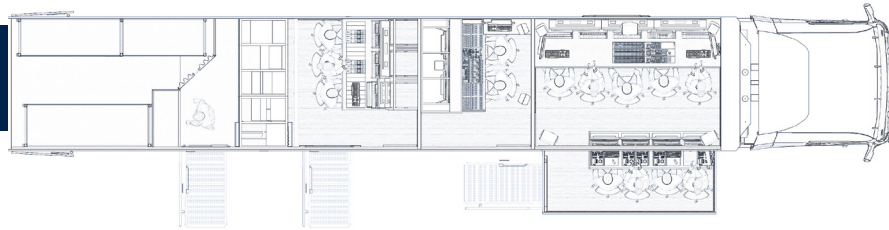

**S16**

Full-size OB trailer

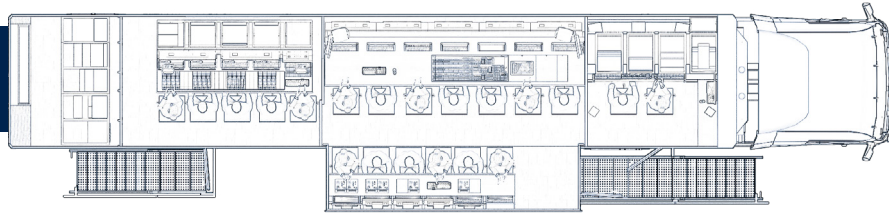

**S24**

Full-size OB trailer

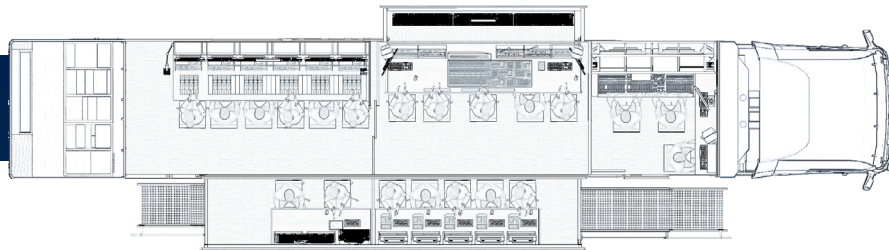

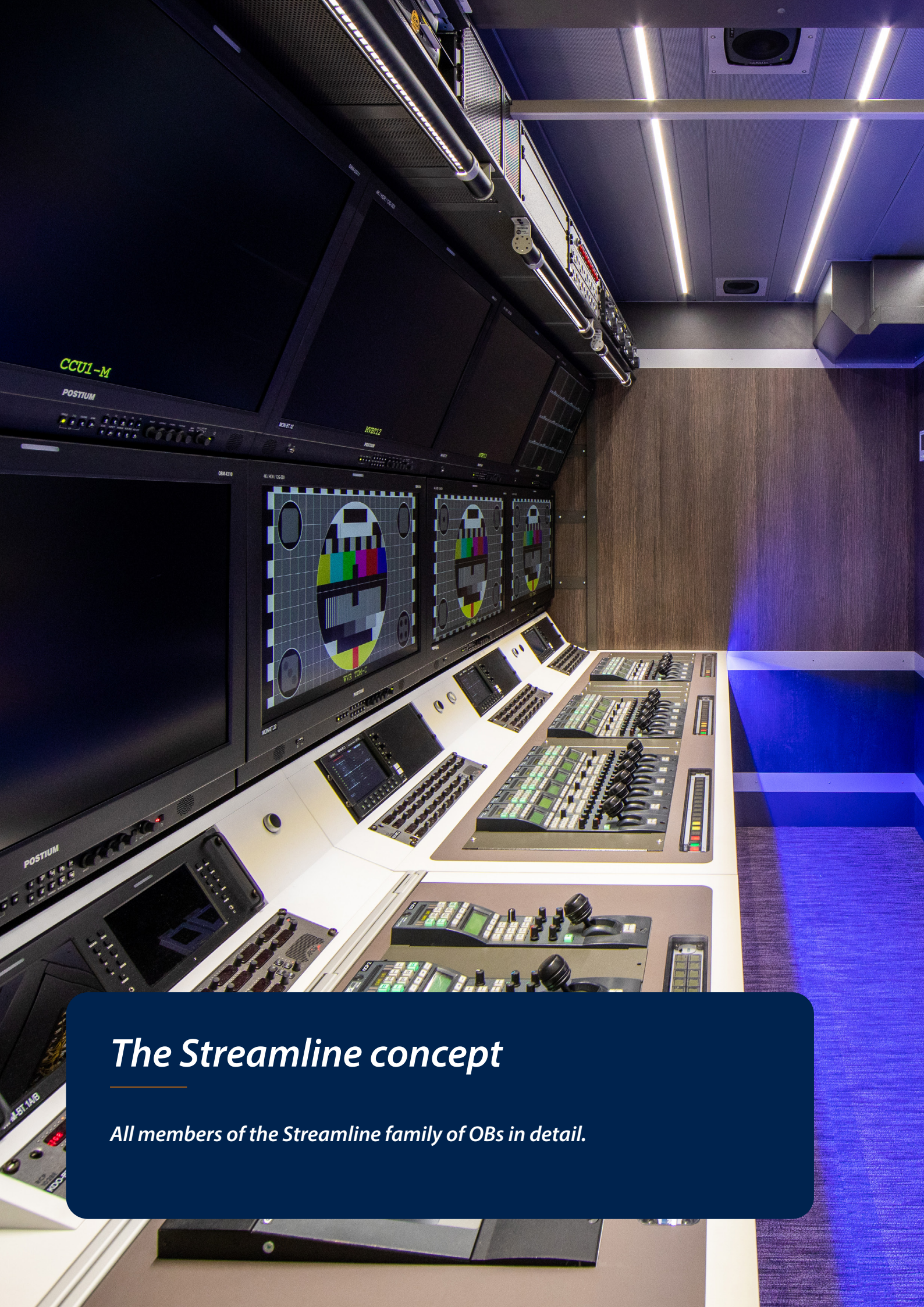

## *The Streamline concept*

*All members of the Streamline family of OBs in detail.*



## Small-size OB in a panel van

*S4 offers five comfortable workplaces, optional SNG capability, and a compact, efficient design based on a 5-ton panel van, making it ideal for versatile and high-quality outside broadcasting.*

### Specifications

<b>Capacity</b>	Up to 5 comfortable workplaces
<b>Layout</b>	Single room configuration
<b>Design</b>	Small-size OB Panel van, sized to access any production site
<b>Optional Features</b>	SNG available upon request
<b>Typical Production Size</b>	Supports up to 4 cameras
<b>Dimensions</b>	(L x W x H in mm): 7,350 x 2,000 x 3,200
<b>Maximum Weight</b>	5 t

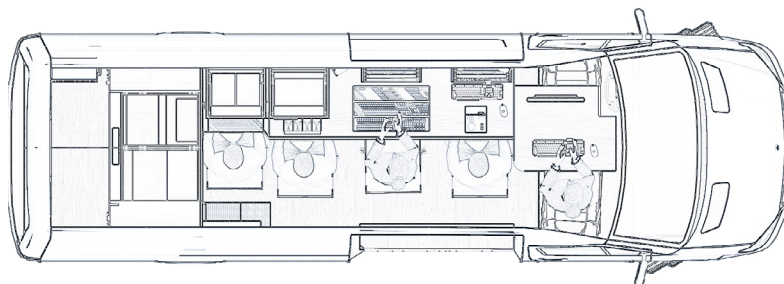



## Medium-size OB truck with integrated storage

An OB truck with storage for up to 8-camera productions that offers the flexibility you need even for larger productions.

### Specifications

Capacity	Up to 9 comfortable workplaces
Layout	1.5-room configuration
Design	Medium-size OB truck with storage
Optional Features	SNG available upon request
Typical Production Size	Supports up to 8 cameras
Dimensions	(L x W x H in mm): 10,000 x 2,550 x 4,000
Maximum Weight	18 t

An OB truck with an integrated storage area for equipment offers several benefits compared to a dedicated additional support van. There will be cost savings due to reduced fleet costs, including fewer costs for vehicle maintenance, logistics, insurance, fuel, and driver salaries. Operational benefits are efficiency, space utilization, flexibility, and workflow improvements.

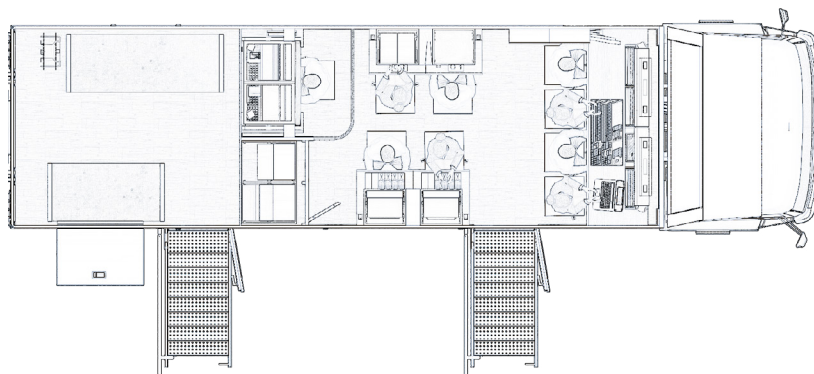



## Medium-size OB truck

*The Streamline S8L offers a spacious and versatile design, accommodating 10-12 comfortable workplaces in a 3-room or 4-room configuration. With flexibility in production layout, it supports either one or two rows, including dedicated areas for production, slomo, audio, and engineering.*

### Specifications

<b>Capacity</b>	10-12 comfortable workplaces (depending on production room arrangement, one or two rows)
<b>Layout</b>	3-room configuration, 3/4 areas
<b>Areas (workplaces)</b>	Production with one row: production / slomo (5), engineering (3), audio (2) Production with two rows: production (4), slomo (3), engineering (3), audio (2)
<b>Design</b>	Medium-size OB truck
<b>Typical Production Size</b>	Supports up to 12 cameras
<b>Dimensions</b>	(L x W x H in mm): 10,000 x 2,550 x 4,000
<b>Maximum Weight</b>	18 t

S8L with 10 workplaces

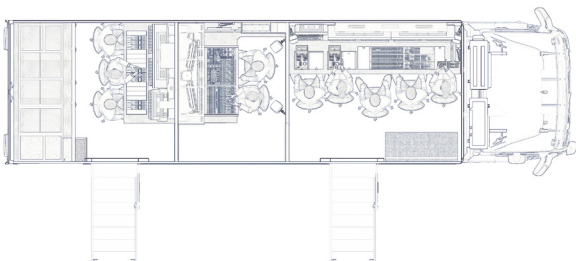

S8L with 12 workplaces

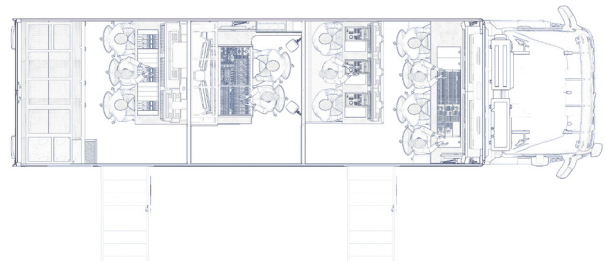

# S12T

## Large-size OB truck

The Streamline S12T features 15 comfortable workplaces in a 3-room, 4-area configuration, including dedicated spaces for production, slomo, audio, and engineering. This OB truck, designed with a single expansion.

## Specifications

Capacity	15 comfortable workplaces
Layout	3-room configuration, 4 areas
Areas (workplaces)	Production (5), slomo (4), engineering (4), audio (2)
Design	Large-size OB truck with side expansion
Typical Production Size	Supports up to 12 cameras
Dimensions	(L x W x H in mm): 12,000 x 2,550 x 4,000 (width extended: 3,800)
Maximum Weight	26 t

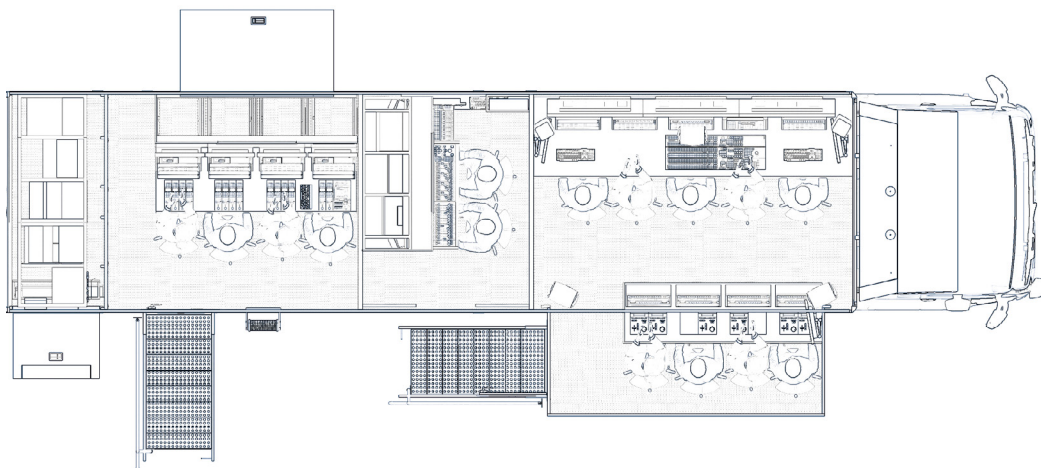

# S16T

## Large-size OB truck

*The Streamline S16T offers a versatile design with 17 comfortable workplaces in a 3-room, 5-area configuration, including spaces for production, slomo, a second production area, engineering, and audio and is equipped with a single expansion and offers maximum space and workplaces packed in a vehicle of this type. In countries with challenging driving conditions, a truck often outmatches a trailer.*

## Specifications

Capacity	17 comfortable workplaces
Layout	3-room configuration, 5 areas
Areas (workplaces)	Production (5), 2nd production (2), slomo (4), engineering (4), audio (2)
Design	Large-size OB truck with side expansion
Typical Production Size	Supports up to 16 cameras
Dimensions	(L x W x H in mm): 12,000 x 2,550 x 4,000 (width extended: 3,800)
Maximum Weight	26 t

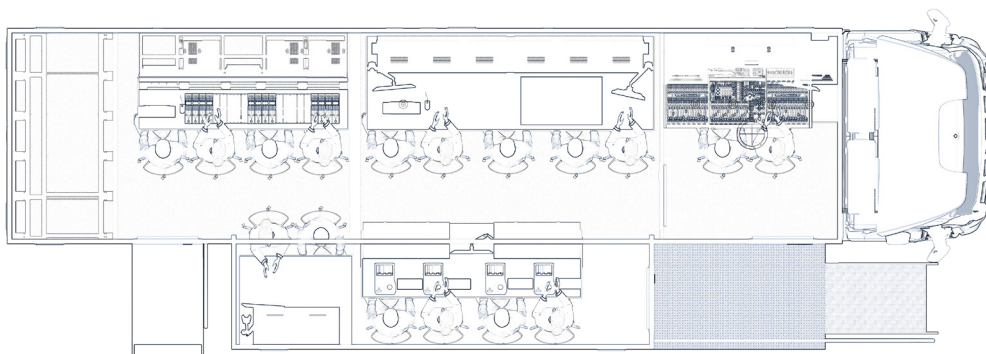

# S16C

## Medium-size OB trailer

*The Streamline S16C is a compact yet powerful OB trailer, offering 18 comfortable workplaces in a 3-room, 5-area configuration. The shorter trailer, equipped with a single expansion, and unique room concepts, provide additional flexibility for productions, making it the ideal solution for all operations requiring manoeuvrability and space.*

## Specifications

<b>Capacity</b>	18 comfortable workplaces
<b>Layout</b>	3-room configuration, 5 areas
<b>Areas (workplaces)</b>	Production (5), slomo (4), 2nd production (3), engineering (4), audio (3)
<b>Design</b>	Medium-size OB trailer with single expansion
<b>Typical Production Size</b>	Supports up to 16 cameras
<b>Dimensions</b>	(L x W x H in mm): 11,700 x 2,550 x 4,000 (width extended: 3,800)
<b>Maximum Weight</b>	30 t (trailer)

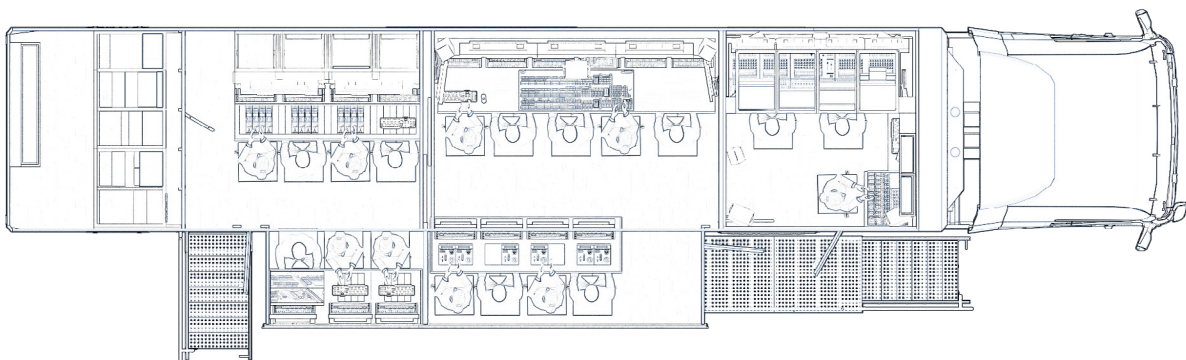



## Full-size OB trailer with integrated storage

The Streamline S12 is a full-size OB trailer designed for maximum efficiency, offering 15 comfortable workplaces within a 3-room, 5-area configuration and includes a storage area, all within a single expansion layout – unique for OBs of this size.

### Specifications

Capacity	15 comfortable workplaces
Layout	3-room configuration, 5 areas
Areas (workplaces)	Production (5), slomo (4), engineering (3), audio (2), storage (1)
Design	Full-size OB trailer with single expansion
Typical Production Size	Supports up to 12 cameras
Dimensions	(L x W x H in mm): 13,600 x 2,550 x 4,000 (width extended: 3,800)
Maximum Weight	30 t (trailer)

An OB trailer with an integrated storage area for equipment offers several benefits compared to a dedicated additional support van. There will be cost savings due to reduced fleet costs, including fewer costs for vehicle maintenance, logistics, insurance, fuel, and driver salaries. Operational benefits are efficiency, space utilization, flexibility, and workflow improvements.

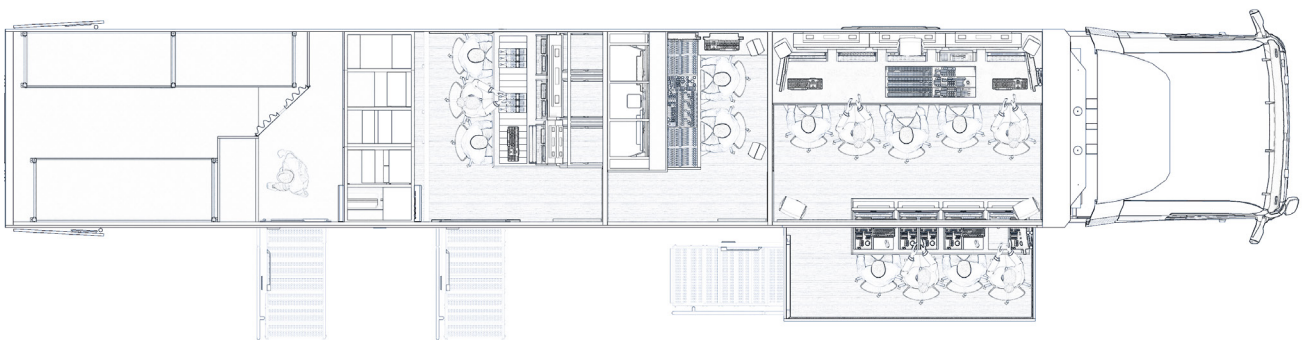

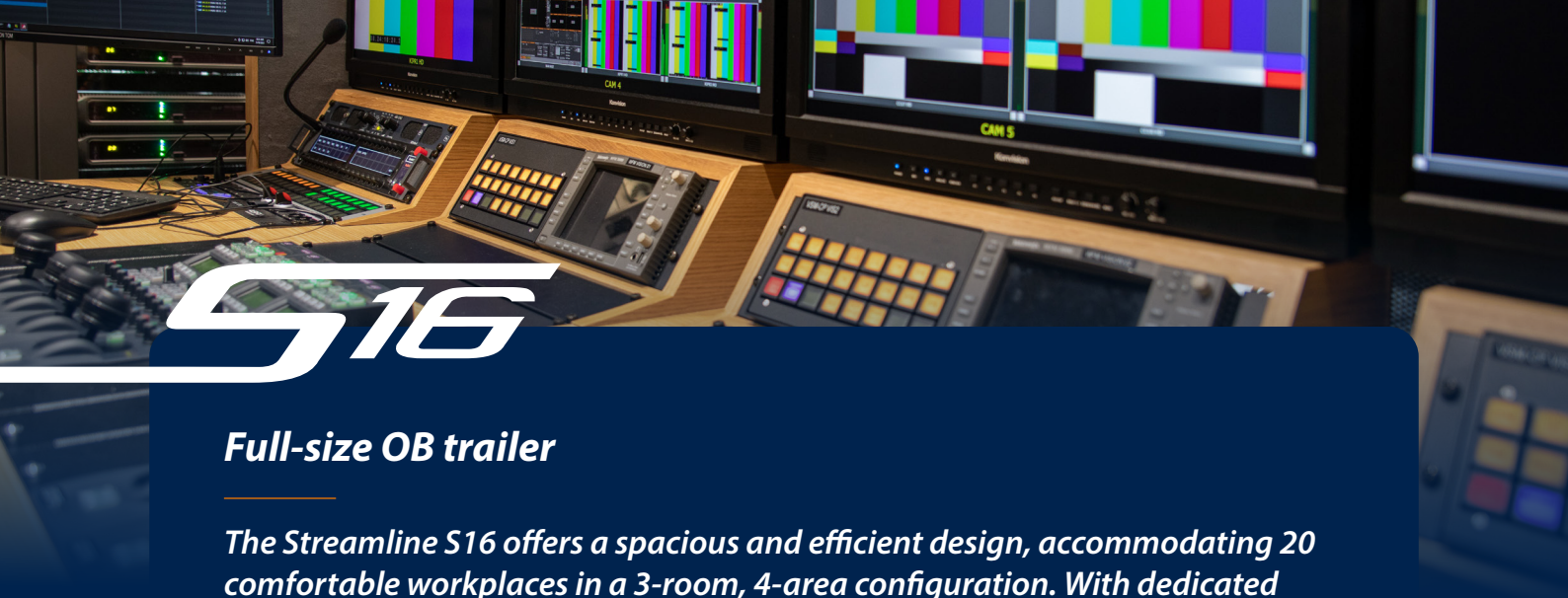

## Full-size OB trailer

The Streamline S16 offers a spacious and efficient design, accommodating 20 comfortable workplaces in a 3-room, 4-area configuration. With dedicated spaces for production, slomo, audio, and engineering, this full-size OB trailer features a single expansion layout optimized for large-scale operations.

### Specifications

Capacity	20 comfortable workplaces
Layout	3-room configuration, 4 areas
Areas (workplaces)	Production (7), slomo (6), engineering (5), audio (2)
Design	Full-size OB trailer with single expansion
Typical Production Size	Supports up to 16 cameras
Dimensions	(L x W x H in mm): 13,600 x 2,550 x 4,000 (width extended: 3,800)
Maximum Weight	30 t (trailer)

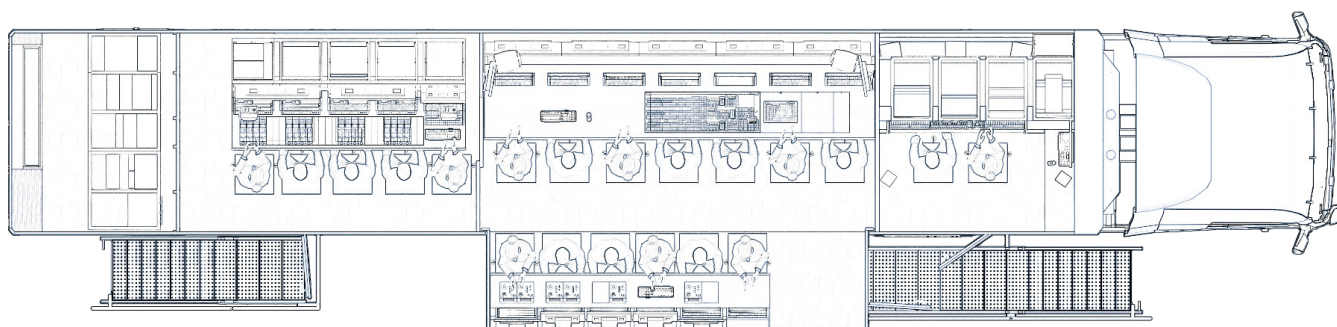

# S24

## Full-size OB trailer

*The Streamline S24 is the largest full-size OB trailer designed for large-scale productions. It offers 21 workplaces in a 3-room, 5-area configuration equipped with double expansion.*

### Specifications

<b>Capacity</b>	21 comfortable workplaces
<b>Layout</b>	3-room configuration, 5 areas
<b>Areas (workplaces)</b>	Production (5), slomo (5), engineering (6), multi engineering (2), audio (3)
<b>Design</b>	Full-size OB trailer with double expansion
<b>Typical Production Size</b>	Supports up to 24 + cameras
<b>Dimensions</b>	(L x W x H in mm): 13,600 x 2,550 x 4,000 (width extended: 4,650)
<b>Maximum Weight</b>	30 t (trailer)

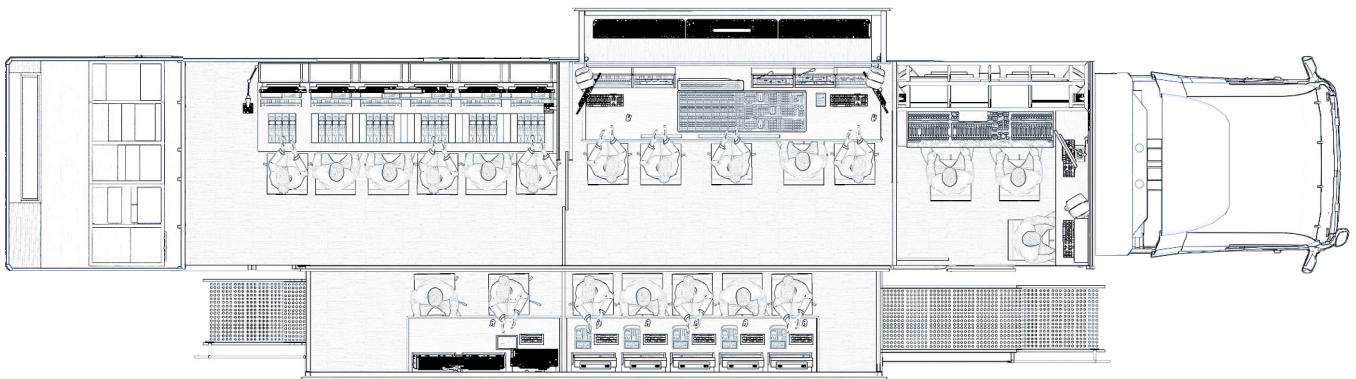

# Tech packages

Layouts/vehicles/builds are available in various fully pre-engineered technology packages.



	OB Van Layout	S4	S8	S8L	S12T	S16T	S16C	S12	S16	S24
Vehicle Type	Panel Van	Truck				Trailer				
Size	Small	Medium		Large		Medium	Full Size			
Standard	UHD									
	HD / 3G									
Control	hi human interface									
IP	Core Routing Processing Multiviewer	n.a.	EVS Neuron							
			t.b.d.							
SDI		Ross Ultrix								
			Riedel MediorNet							
IP	Vision Mixer	Grass Valley								
		Sony								
		Ross Carbonite / Acuity								
IP	Server	t.b.d.	EVS XT VIA							
			t.b.d.							
IP	Cameras	Sony								
		Grass Valley								
	Intercom		Riedel Artist							
	Audio	n.a.	Calrec							
			LAWO							



# Technology for today and tomorrow

---

**4K and HDR Ultra HD; SDI, NDI and ST2110 IP connectivity; simple configuration, connectivity and interworking.**



## **Flexibility**

We know that outside broadcast units have to be flexible, moving continually between venues and changing workflows and configurations to suit each new production. That is why each Streamline unit is equipped with hi human interface, our uniquely powerful and intuitive control environment, capable of resetting the entire truck with a single click.

The modular engineering of Streamline allows you to choose the facilities and the layout, so your team works the way you need them to. Expert design ensures the maximum available workspace in each size of vehicle. You get a vehicle tailored to your requirements, but with all the advantages of a standard design.



Broadcast Solutions works with the leading vendors in the industry to ensure that every element of the technical design is proven, stable, and future-proof. You choose to work in SDI (including 12G-SDI for 4K Ultra HD), in IP or as a hybrid. All standards are supported. Everything in the design relies on open standards, including NMOS, Dante and NDI as well as SMPTE ST2110, to ensure complete compatibility and interoperability.

By choosing a Streamline outside broadcast unit you choose the configuration, capacity and capabilities you need. You determine the layout and the workspaces. You get a truck to your bespoke design, but because it is built on pre-engineered modules and proven engineering it is built far faster than a custom vehicle, and at a significant cost saving.

***“That is why Streamline is the most successful outside broadcast family in the world, with large numbers of units now in constant use, delivering premium programming.”***

# Streamline IP powered by EVS

*A simple, proven route to a mobile SMPTE ST2110 production powerhouse.*



Working with fellow industry leader EVS, Broadcast Solutions has created a comprehensive package solution for end-to-end IP production. This advanced solution provides everything you need for seamless ST2110 workflows, all meticulously pre-configured for optimal performance and maximum flexibility.



## Choosing the Streamline IP signature pack gives you:

- ▶ **Unmatched efficiency**  
The power of a fully integrated solution featuring EVS Neuron gateways, processors and multiviewers working seamlessly together, eliminating the need for complex configuration to save you set-up time and resources.
- ▶ **Enhanced replay and recording**  
Incorporating the industry-standard EVS XT-VIA servers gives you all the capture and replay functionality you need, in pristine quality and with familiar workflows.
- ▶ **Intuitive control**  
The ground-breaking hi human interface control layer enables your team to power through workflows and configurations, recalling even the most complex set-ups with a single click.
- ▶ **SMPTE ST2110 and NMOS**  
Seamless integration with modern IP workflows across live production and delivery, creating a future-proof environment for effortless adaptation to evolving broadcast standards.

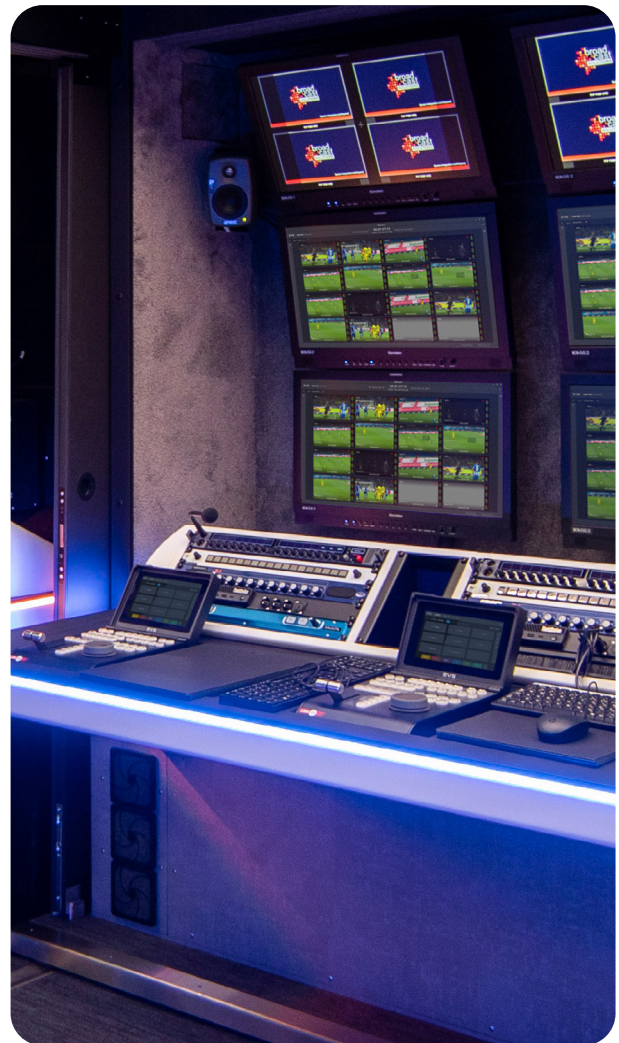

# IP-ready baseband routing

IP-based baseband routing options provide future-proof adaptable Streamline OBs.



In the rapidly evolving world of broadcast technology, the shift from traditional Serial Digital Interface (SDI) systems to Internet Protocol (IP)-based infrastructure represents a significant advancement. As the demands for higher-quality video and audio production increase, so does the need for more efficient and reliable routing

systems, particularly in the challenging environments of mobile broadcasting. The arkona manifold solution, featuring BLADE//runner Programmable Acceleration Cards (PACs), exemplifies the cutting-edge approach to IP-based baseband routing, offering numerous advantages over conventional SDI systems.



## Adaptable retrofitting

Easy retrofitting of existing broadcast infrastructure with our routing technology. Our technology can be easily integrated into existing OB vans and broadcast infrastructures. Existing SDI routers can be easily replaced.

## Future-proof adaptation and integration

Keeps the Streamline family ahead in the shift towards IP-based technologies, maintaining relevance and efficiency.

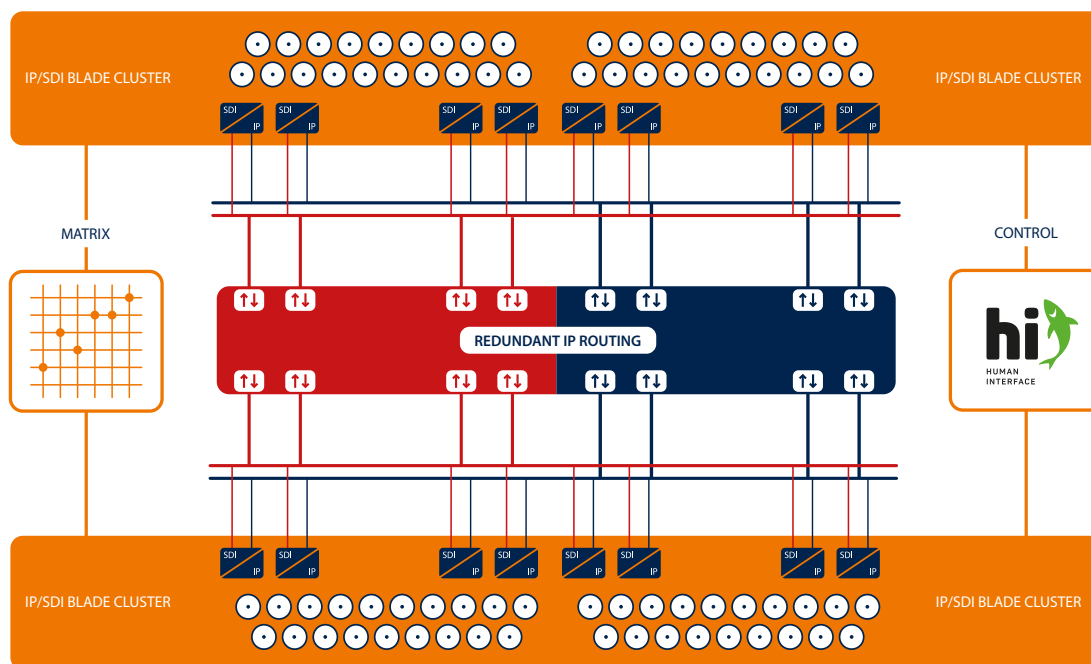

# Streamline common features



## Air conditioning

Broadcast Solutions specializes in the planning, design, and installation of air conditioning systems. We collaborate with leading manufacturers to provide both installation and service.

- Individual climate control circuits for each room.
- Separate climate control circuit for the technical room.
- Possible temperature range: -30 °C to +53 °C.
- Complete air exchange of up to 6 times per hour.
- Perforated ceilings for comfortable working conditions.
- Installation of outdoor units in the underfloor area or on the front side.
- Heat exchange unit for fresh air circulation is available.



## Air Purification and UV-C irradiation

Our advanced air purification systems effectively remove particles, bacteria, and viruses from indoor air.

- Installation possible in the roof and underfloor compartments.
- Recirculation system with H13 filter and UV-C light.
- Particle filter eliminates more than 99.95 % of dust, bacteria, and viruses.
- Air-purification suitable for continuous operation during production.

*\*Not included with S4*

## Streamline common features



### Noise reduction: Encapsulated low-noise racks

Installing encapsulated low-noise racks with sound insulation doors in OB trucks and OB trailers ensure silent and efficient working conditions.

- Fully enclosed racks with precision-engineered encapsulation to minimize noise emission.
- Noise reduction up to 30 dB.
- High-performance sound insulation doors with multi-layered insulation materials to block and absorb sound and vibrations.
- Customizable sizes available to fit the specific needs of different OB vehicles.



### Weather protection roof

- Even with rigid weather protection roofs, we comply with EU regulations of 2.55 m maximum width.

### UPS-buffered power supply

- Installation in the underfloor compartments.
- Power supply (depending on model: 3 x 3 kVA to 3 x 11 KVA (increments: 3, 5, 6, 8, 11) single-phase).
- Also available with lithium-ion battery technology
- Ensures controlled shut-down.
- Offers uninterrupted autonomous operation of crucial broadcast technology.

\*Not included with S4

## Support vans and generators

*Ample space and well-considered solutions are crucial for success in live television productions. One of the key elements of Streamline's achievements is our innovative room and vehicle designs.*



### Optimised space usage

Two of our Streamline OB vans have storage areas to accommodate all cameras and additional equipment. If a Streamline OB van lacks a built-in storage room, we offer support vans and generators to accompany the OB. Our support vans can be customised to suit almost any requirement. Beyond advanced storage options, we can incorporate restrooms, kitchenettes, secondary production room or office spaces.

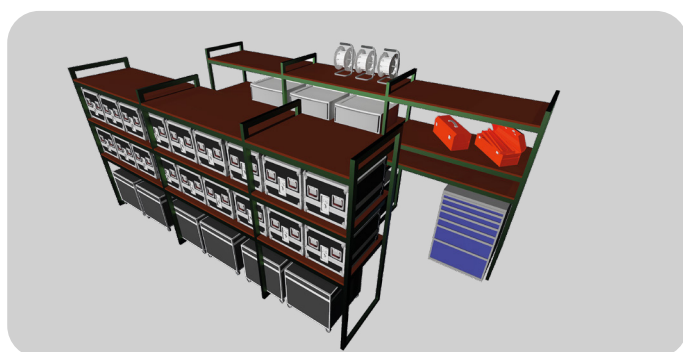

### Customised storage solutions

Our storage systems are bespoke and designed to maximise space for cameras, lenses, tripods, cable drums, and more. They are the result of years of experience in building OB vans, combined with thoughtful design concepts and valuable customer feedback, resulting in tailored solutions that meet individual needs.

### Generator solutions

We offer various generator solutions for customers requiring additional power to enhance flexibility in field production. Depending on the specific needs of the production, these can be integrated within the OB van, housed in the support van, or provided as standalone trailer units.



# hi human interface



Seamless, intuitive, comprehensive system configuration and control.



hi human interface is the first truly intuitive control environment for rich broadcast and live event infrastructures. Developed by software engineers at Broadcast Solutions, it has all the capabilities needed to manage complex technical architectures in a simple and speedy manner.

In a modern production environment, like a Streamline truck, the technical architecture is inevitably complex, with processing from multiple vendors, large numbers of sources and destinations, and different formats and resolutions. All has to be managed without compromising quality or accuracy.

To deliver a perfect outcome every time demands complete and confident control. This is where hi human interface excels.

It pulls all the strands together – video, audio, data, control, baseband, SMPTE ST2110, Dante audio, NDI and more – and puts everything under a simple, common control. Far more than simple routing, hi controls all the functionality of the connected systems: cueing, switching and adjusting.

In large-scale productions, hi instances on interconnected production hubs act as a single system. Power Widgets add specific controls, like PTZ cameras or servers, and are used to build complex workflows with multiple interactions triggered by a single click.

hi is completely vendor agnostic, supporting all leading vendors and technologies. It incorporates NMOS, Dante and NDI device discovery, so additional equipment just needs to be connected to the network and identified before being added to the workflow map. Each set-up is stored in hi, and can be instantly recalled and established when the truck next covers an event.

The interface is so intuitive that anyone familiar with a smartphone will be immediately at ease. It delivers remarkable comprehensive control of the complete production network in and around the Streamline truck.





**Broadcast Solutions GmbH**

Alfred-Nobel-Straße 5 / 55411 Bingen am Rhein / Germany

Phone: +49 (0) 6721 4008 0 / Fax +49 (0) 6721 4008 27

info@broadcast-solutions.de / [www.broadcast-solutions.de](http://www.broadcast-solutions.de)